

STEMPEL UND MATRIZEN FÜR MASCHINEN PEDDINGHAUS

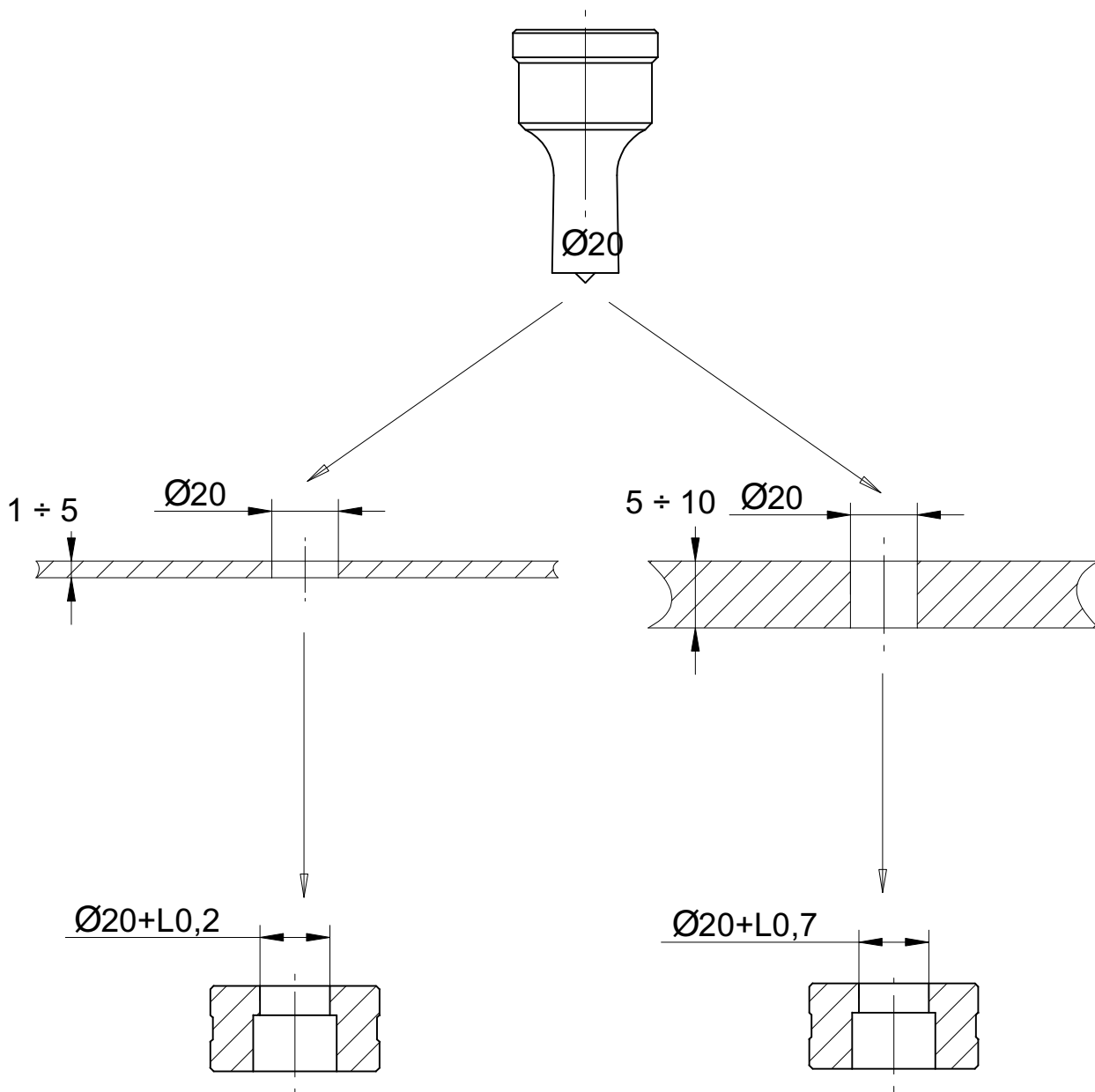

wromet.com.pl

<h2>Machinenetype für Peddinghaus</h2>				
A	Stempel u. Matrizen zur Stempelschnellspannvor- richtung	Peddicat 360/361 Peddiworker 500/600 Peddiworker 800 Peddimaster 60/80 Peddimaster 80/110 Hydraulic 300/500 Forax 15 – 25 – 45 – 65 – 150 – 250 – 450, 225 B/11– 13 – 45 – 60, 225 H/11 – 13 210 Standard 11 – 13, 210 SUPER 11 – 13, Hydraulic60 – 600 – 40, Stanzfix Peddimaster 450 M, Peddimaster 28/40 – 40/60 – Peddimaster 60/100 – Peddiworker 400 – 600		
B	Stempel u. Matrizen zur Stempelschnellspannvor- richtung	<table style="width: 100%; border: none;"> <tr> <td style="width: 50%;"> Peddicat No. 1 Peddicat 361 Peddicat 380 Peddicat 500 Peddiworker No. 1 Peddiworker 501 Peddiworker 502 Peddiworker 801/802 Hydraulic 100 Hydraulic 280 Hydraulic 301 Hydraulic 501 Hydraulic 502 Hydraulic 800 </td> <td style="width: 50%;"> Hydraulic 1000/1001 Peddimaster 800/1100 Peddimaster 1100/1700 Peddimaster 110/170 Peddimaster 60/100 H Peddiworker 1000 G Peddimax 110/140 Peddimax 600 Peddimax 601 Peddimax 602 Peddimax 800 Peddimax 801 Peddimax 1002 Peddimaster 100/160 H Forax 80 – 100 – 1000, 225 B/16 – 20 – 80 – 100, 225 H/16 – 20 210 Standard 16, 210 SUPER 16 – 20 </td> </tr> </table>	Peddicat No. 1 Peddicat 361 Peddicat 380 Peddicat 500 Peddiworker No. 1 Peddiworker 501 Peddiworker 502 Peddiworker 801/802 Hydraulic 100 Hydraulic 280 Hydraulic 301 Hydraulic 501 Hydraulic 502 Hydraulic 800	Hydraulic 1000/1001 Peddimaster 800/1100 Peddimaster 1100/1700 Peddimaster 110/170 Peddimaster 60/100 H Peddiworker 1000 G Peddimax 110/140 Peddimax 600 Peddimax 601 Peddimax 602 Peddimax 800 Peddimax 801 Peddimax 1002 Peddimaster 100/160 H Forax 80 – 100 – 1000, 225 B/16 – 20 – 80 – 100, 225 H/16 – 20 210 Standard 16, 210 SUPER 16 – 20
Peddicat No. 1 Peddicat 361 Peddicat 380 Peddicat 500 Peddiworker No. 1 Peddiworker 501 Peddiworker 502 Peddiworker 801/802 Hydraulic 100 Hydraulic 280 Hydraulic 301 Hydraulic 501 Hydraulic 502 Hydraulic 800	Hydraulic 1000/1001 Peddimaster 800/1100 Peddimaster 1100/1700 Peddimaster 110/170 Peddimaster 60/100 H Peddiworker 1000 G Peddimax 110/140 Peddimax 600 Peddimax 601 Peddimax 602 Peddimax 800 Peddimax 801 Peddimax 1002 Peddimaster 100/160 H Forax 80 – 100 – 1000, 225 B/16 – 20 – 80 – 100, 225 H/16 – 20 210 Standard 16, 210 SUPER 16 – 20			
C	Stempel u. Matrizen zur Stempelschnellspannvor- richtung	Sonderstanzvorrichtung bis 39 – 58 – 90 für alle Modelle Hydraulic 1000 N Hydraulic 1400 N 225 B/25 – 130 Hydraulic – 140 210 SUPER 25 Zur Sonderstanzvorrichtung für alle Modelle und Größen		



Der Stempel bestimmt die Größe des stanzenden Loches.
 Das Loch der Matrize entspricht der Größe des Stempels + Schneidspiel.
 Für die dünne Bleche fertigen wir 0,2 mm und für die dicke Bleche 0,7 mm.
 Wir haben eine Möglichkeit auch Sonderstempel und -Matrizen fertigen
 (d.h. Sondergröße und Eigenschneidspalt)

	<p>Rundstempel ř (mm)</p> <table border="1"> <tbody> <tr><td>3,0</td><td>6,0</td><td>9,0</td><td>12,0</td></tr> <tr><td>3,5</td><td>6,5</td><td>9,5</td><td>12,5</td></tr> <tr><td>4,0</td><td>7,0</td><td>10,0</td><td>13,0</td></tr> <tr><td>4,5</td><td>7,5</td><td>10,5</td><td>13,5</td></tr> <tr><td>5,0</td><td>8,0</td><td>11,0</td><td>14,0</td></tr> <tr><td>5,5</td><td>8,5</td><td>11,5</td><td></td></tr> </tbody> </table>	3,0	6,0	9,0	12,0	3,5	6,5	9,5	12,5	4,0	7,0	10,0	13,0	4,5	7,5	10,5	13,5	5,0	8,0	11,0	14,0	5,5	8,5	11,5		<p>NR 1</p>												
3,0	6,0	9,0	12,0																																			
3,5	6,5	9,5	12,5																																			
4,0	7,0	10,0	13,0																																			
4,5	7,5	10,5	13,5																																			
5,0	8,0	11,0	14,0																																			
5,5	8,5	11,5																																				
		<p>C</p>																																				
	<p>Rundstempel ř (mm)</p> <table border="1"> <tbody> <tr><td>3,0</td><td>6,0</td><td>9,0</td><td>12,0</td><td>15,0</td><td>18,0</td></tr> <tr><td>3,5</td><td>6,5</td><td>9,5</td><td>12,5</td><td>15,5</td><td>18,5</td></tr> <tr><td>4,0</td><td>7,0</td><td>10,0</td><td>13,0</td><td>16,0</td><td>19,0</td></tr> <tr><td>4,5</td><td>7,5</td><td>10,5</td><td>13,5</td><td>16,5</td><td></td></tr> <tr><td>5,0</td><td>8,0</td><td>11,0</td><td>14,0</td><td>17,0</td><td></td></tr> <tr><td>5,5</td><td>8,5</td><td>11,5</td><td>14,5</td><td>17,5</td><td></td></tr> </tbody> </table>	3,0	6,0	9,0	12,0	15,0	18,0	3,5	6,5	9,5	12,5	15,5	18,5	4,0	7,0	10,0	13,0	16,0	19,0	4,5	7,5	10,5	13,5	16,5		5,0	8,0	11,0	14,0	17,0		5,5	8,5	11,5	14,5	17,5		<p>NR 2</p>
3,0	6,0	9,0	12,0	15,0	18,0																																	
3,5	6,5	9,5	12,5	15,5	18,5																																	
4,0	7,0	10,0	13,0	16,0	19,0																																	
4,5	7,5	10,5	13,5	16,5																																		
5,0	8,0	11,0	14,0	17,0																																		
5,5	8,5	11,5	14,5	17,5																																		
		<p>C</p>																																				
	<p>Langlochstempel (mm)</p> <table border="1"> <tbody> <tr><td>5,0x10,0</td><td>6,5x18,0</td></tr> <tr><td>5,0x14,0</td><td>7,5x14,0</td></tr> <tr><td>5,5x10,0</td><td>9,0x14,0</td></tr> <tr><td>5,5x14,0</td><td>9,0x18,0</td></tr> <tr><td>5,5x19,0</td><td>10,0x14,0</td></tr> <tr><td>6,5x12,0</td><td></td></tr> </tbody> </table>	5,0x10,0	6,5x18,0	5,0x14,0	7,5x14,0	5,5x10,0	9,0x14,0	5,5x14,0	9,0x18,0	5,5x19,0	10,0x14,0	6,5x12,0		<p>NR 2</p>																								
5,0x10,0	6,5x18,0																																					
5,0x14,0	7,5x14,0																																					
5,5x10,0	9,0x14,0																																					
5,5x14,0	9,0x18,0																																					
5,5x19,0	10,0x14,0																																					
6,5x12,0																																						
		<p>C</p>																																				
	<p>Vierkantstempel (mm)</p> <table border="1"> <tbody> <tr><td>4,0</td><td>9,0</td></tr> <tr><td>5,0</td><td>10,0</td></tr> <tr><td>6,0</td><td>11,0</td></tr> <tr><td>7,0</td><td>12,0</td></tr> <tr><td>8,0</td><td>13,0</td></tr> </tbody> </table>	4,0	9,0	5,0	10,0	6,0	11,0	7,0	12,0	8,0	13,0	<p>NR 2</p>																										
4,0	9,0																																					
5,0	10,0																																					
6,0	11,0																																					
7,0	12,0																																					
8,0	13,0																																					
		<p>C</p>																																				
	<p>Rechteck (mm)</p> <table border="1"> <tbody> <tr><td>3x4÷3x18</td><td>9x10÷9x16</td></tr> <tr><td>4x5÷4x18</td><td>10x11÷10x16</td></tr> <tr><td>5x6÷5x18</td><td>11x12÷11x15</td></tr> <tr><td>6x7÷6x18</td><td>12x13÷12x14</td></tr> <tr><td>7x8÷7x17</td><td></td></tr> <tr><td>8x9÷8x17</td><td></td></tr> </tbody> </table>	3x4÷3x18	9x10÷9x16	4x5÷4x18	10x11÷10x16	5x6÷5x18	11x12÷11x15	6x7÷6x18	12x13÷12x14	7x8÷7x17		8x9÷8x17		<p>NR 2</p>																								
3x4÷3x18	9x10÷9x16																																					
4x5÷4x18	10x11÷10x16																																					
5x6÷5x18	11x12÷11x15																																					
6x7÷6x18	12x13÷12x14																																					
7x8÷7x17																																						
8x9÷8x17																																						
		<p>C</p>																																				

	<p>Rundstempel \checkmark (mm)</p> <p>5,0 ÷ 26,0 Größe von 0,5 mm</p>	<p>NR 3</p>															
		<p>C</p>															
	<p>Langlochstempel (mm)</p> <p>5,0x10,0 ÷ 10,0x19,0 Größe von 0,5 mm</p>	<p>NR 3</p>															
		<p>C</p>															
	<p>Vierkantstempel (mm)</p> <table border="1"> <tbody> <tr><td>8,0</td><td>13,0</td><td>18,0</td></tr> <tr><td>9,0</td><td>14,0</td><td></td></tr> <tr><td>10,0</td><td>15,0</td><td></td></tr> <tr><td>11,0</td><td>16,0</td><td></td></tr> <tr><td>12,0</td><td>17,0</td><td></td></tr> </tbody> </table>	8,0	13,0	18,0	9,0	14,0		10,0	15,0		11,0	16,0		12,0	17,0		<p>NR 3</p>
8,0	13,0	18,0															
9,0	14,0																
10,0	15,0																
11,0	16,0																
12,0	17,0																
		<p>C</p>															
	<p>Rechteck (mm)</p> <table border="1"> <tbody> <tr><td>8x9÷8x24</td><td>13x14÷13x22</td></tr> <tr><td>9x10÷9x24</td><td>14x15÷14x21</td></tr> <tr><td>10x11÷10x24</td><td>15x16÷15x20</td></tr> <tr><td>11x12÷11x23</td><td>16x17÷16x19</td></tr> <tr><td>12x13÷12x23</td><td>17x18÷17x19</td></tr> </tbody> </table>	8x9÷8x24	13x14÷13x22	9x10÷9x24	14x15÷14x21	10x11÷10x24	15x16÷15x20	11x12÷11x23	16x17÷16x19	12x13÷12x23	17x18÷17x19	<p>NR 3</p>					
8x9÷8x24	13x14÷13x22																
9x10÷9x24	14x15÷14x21																
10x11÷10x24	15x16÷15x20																
11x12÷11x23	16x17÷16x19																
12x13÷12x23	17x18÷17x19																
		<p>C</p>															
	<p>Exzenterstempel (mm)</p> <table border="1"> <tbody> <tr><td>8,0</td><td>13,0</td></tr> <tr><td>9,0</td><td>14,0</td></tr> <tr><td>10,0</td><td>15,0</td></tr> <tr><td>11,0</td><td></td></tr> <tr><td>12,0</td><td></td></tr> </tbody> </table>	8,0	13,0	9,0	14,0	10,0	15,0	11,0		12,0		<p>NR 3</p>					
8,0	13,0																
9,0	14,0																
10,0	15,0																
11,0																	
12,0																	
		<p>C</p>															

	<p>Rundstempel \checkmark (mm)</p> <p>5,0 ÷ 26,0 Größe von 0,5 mm</p>	<p>NR 4</p> <p>A</p>															
	<p>Langlochstempel (mm)</p> <p>5,0x10,0 ÷ 10,0x19,0 Größe von 0,5 mm</p>	<p>NR 4</p> <p>A</p>															
	<p>Vierkantstempel (mm)</p> <table border="1"> <tbody> <tr><td>8,0</td><td>13,0</td><td>18,0</td></tr> <tr><td>9,0</td><td>14,0</td><td></td></tr> <tr><td>10,0</td><td>15,0</td><td></td></tr> <tr><td>11,0</td><td>16,0</td><td></td></tr> <tr><td>12,0</td><td>17,0</td><td></td></tr> </tbody> </table>	8,0	13,0	18,0	9,0	14,0		10,0	15,0		11,0	16,0		12,0	17,0		<p>NR 4</p> <p>A</p>
8,0	13,0	18,0															
9,0	14,0																
10,0	15,0																
11,0	16,0																
12,0	17,0																
	<p>Rechteck (mm)</p> <table border="1"> <tbody> <tr><td>8x9÷8x24</td><td>13x14÷13x22</td></tr> <tr><td>9x10÷9x24</td><td>14x15÷14x21</td></tr> <tr><td>10x11÷10x24</td><td>15x16÷15x20</td></tr> <tr><td>11x12÷11x23</td><td>16x17÷16x19</td></tr> <tr><td>12x13÷12x23</td><td>17x18÷17x19</td></tr> </tbody> </table>	8x9÷8x24	13x14÷13x22	9x10÷9x24	14x15÷14x21	10x11÷10x24	15x16÷15x20	11x12÷11x23	16x17÷16x19	12x13÷12x23	17x18÷17x19	<p>NR 4</p> <p>A</p>					
8x9÷8x24	13x14÷13x22																
9x10÷9x24	14x15÷14x21																
10x11÷10x24	15x16÷15x20																
11x12÷11x23	16x17÷16x19																
12x13÷12x23	17x18÷17x19																
	<p>Exzenterstempel (mm)</p> <table border="1"> <tbody> <tr><td>8,0</td><td>13,0</td></tr> <tr><td>9,0</td><td>14,0</td></tr> <tr><td>10,0</td><td>15,0</td></tr> <tr><td>11,0</td><td></td></tr> <tr><td>12,0</td><td></td></tr> </tbody> </table>	8,0	13,0	9,0	14,0	10,0	15,0	11,0		12,0		<p>NR 4</p> <p>A</p>					
8,0	13,0																
9,0	14,0																
10,0	15,0																
11,0																	
12,0																	

	<p>Rundstempel \checkmark (mm)</p> <p>3,0 ÷ 30,5 Größe von 0,5 mm</p>	<p>NR 5</p> <p>B</p>														
	<p>Langlochstempel (mm)</p> <p>5,5x10 ÷ 22,0x31,0 Größe von 0,5 mm</p>	<p>NR 5</p> <p>B</p>														
	<p>Vierkantstempel (mm)</p> <p>6,0 ÷ 22,0 Größe von 1 mm</p>	<p>NR 5</p> <p>B</p>														
	<p>Rechteck (mm)</p> <table border="1"> <tbody> <tr> <td>8x9÷8x26</td> <td>15x16÷15x26</td> </tr> <tr> <td>9x10÷9x24</td> <td>16x17÷16x26</td> </tr> <tr> <td>10x11÷10x26</td> <td>17x18÷17x25</td> </tr> <tr> <td>11x12÷11x26</td> <td>18x19÷18x25</td> </tr> <tr> <td>12x13÷12x26</td> <td>19x20÷20x24</td> </tr> <tr> <td>13x14÷13x26</td> <td></td> </tr> <tr> <td>14x15÷14x26</td> <td></td> </tr> </tbody> </table>	8x9÷8x26	15x16÷15x26	9x10÷9x24	16x17÷16x26	10x11÷10x26	17x18÷17x25	11x12÷11x26	18x19÷18x25	12x13÷12x26	19x20÷20x24	13x14÷13x26		14x15÷14x26		<p>NR 5</p> <p>B</p>
8x9÷8x26	15x16÷15x26															
9x10÷9x24	16x17÷16x26															
10x11÷10x26	17x18÷17x25															
11x12÷11x26	18x19÷18x25															
12x13÷12x26	19x20÷20x24															
13x14÷13x26																
14x15÷14x26																
	<p>Exzenterstempel (mm)</p> <table border="1"> <tbody> <tr> <td>8,0</td> <td>13,0</td> </tr> <tr> <td>9,0</td> <td>14,0</td> </tr> <tr> <td>10,0</td> <td>15,0</td> </tr> <tr> <td>11,0</td> <td></td> </tr> <tr> <td>12,0</td> <td></td> </tr> </tbody> </table>	8,0	13,0	9,0	14,0	10,0	15,0	11,0		12,0		<p>NR 5</p> <p>B</p>				
8,0	13,0															
9,0	14,0															
10,0	15,0															
11,0																
12,0																

	<p>Rundstempel r̄ (mm)</p> <p>3,0 ÷ 39,5 Größe von 0,5 mm</p>	<p>NR 6</p>															
		<p>C</p>															
	<p>Langlochstempel (mm)</p> <p>5,5x10 ÷ 22,0x39,0 Größe von 0,5 mm</p>	<p>NR 6</p>															
		<p>C</p>															
	<p>Vierkantstempel (mm)</p> <p>6,0 ÷ 28,0 Größe von 1 mm</p>	<p>NR 6</p>															
		<p>C</p>															
	<p>Rechteck (mm)</p> <table border="1"> <tbody> <tr> <td>8x9÷8x26</td> <td>15x16÷15x32</td> </tr> <tr> <td>9x10÷9x32</td> <td>16x17÷16x32</td> </tr> <tr> <td>10x11÷10x32</td> <td>17x18÷17x32</td> </tr> <tr> <td>11x12÷11x32</td> <td>18x19÷18x32</td> </tr> <tr> <td>12x13÷12x32</td> <td>19x20÷20x32</td> </tr> <tr> <td>13x14÷13x32</td> <td>24x25÷24x30</td> </tr> <tr> <td>14x15÷14x32</td> <td></td> </tr> </tbody> </table>	8x9÷8x26	15x16÷15x32	9x10÷9x32	16x17÷16x32	10x11÷10x32	17x18÷17x32	11x12÷11x32	18x19÷18x32	12x13÷12x32	19x20÷20x32	13x14÷13x32	24x25÷24x30	14x15÷14x32		<p>NR 6</p>	
8x9÷8x26	15x16÷15x32																
9x10÷9x32	16x17÷16x32																
10x11÷10x32	17x18÷17x32																
11x12÷11x32	18x19÷18x32																
12x13÷12x32	19x20÷20x32																
13x14÷13x32	24x25÷24x30																
14x15÷14x32																	
		<p>C</p>															
	<p>Exzenterstempel (mm)</p> <table border="1"> <tbody> <tr> <td>8,0</td> <td>13,0</td> <td>18,0</td> </tr> <tr> <td>9,0</td> <td>14,0</td> <td>19,0</td> </tr> <tr> <td>10,0</td> <td>15,0</td> <td>20,0</td> </tr> <tr> <td>11,0</td> <td>16,0</td> <td></td> </tr> <tr> <td>12,0</td> <td>17,0</td> <td></td> </tr> </tbody> </table>	8,0	13,0	18,0	9,0	14,0	19,0	10,0	15,0	20,0	11,0	16,0		12,0	17,0		<p>NR 6</p>
8,0	13,0	18,0															
9,0	14,0	19,0															
10,0	15,0	20,0															
11,0	16,0																
12,0	17,0																
		<p>C</p>															

	<p>Rundstempel \checkmark (mm)</p> <p>20,0 ÷ 50,5 Größe von 0,5 mm</p>	<p>NR 7</p> <p>C</p>														
	<p>Langlochstempel (mm)</p> <p>5,5x58,5 ÷ 50x58,5 Größe von 0,5 mm</p>	<p>NR 7</p> <p>C</p>														
	<p>Vierkantstempel (mm)</p> <p>20,0 ÷ 41,0 Größe von 1 mm</p>	<p>NR 7</p> <p>C</p>														
	<p>Rechteck (mm)</p> <table border="1"> <tbody> <tr> <td>8x9÷8x56</td> <td>15x16÷15x50</td> </tr> <tr> <td>9x10÷9x50</td> <td>16x17÷16x50</td> </tr> <tr> <td>10x11÷10x50</td> <td>17x18÷17x50</td> </tr> <tr> <td>11x12÷11x50</td> <td>18x19÷18x50</td> </tr> <tr> <td>12x13÷12x50</td> <td>19x20÷20x50</td> </tr> <tr> <td>13x14÷13x50</td> <td>24x25÷24x50</td> </tr> <tr> <td>14x15÷14x50</td> <td>35x36÷35x44</td> </tr> </tbody> </table>	8x9÷8x56	15x16÷15x50	9x10÷9x50	16x17÷16x50	10x11÷10x50	17x18÷17x50	11x12÷11x50	18x19÷18x50	12x13÷12x50	19x20÷20x50	13x14÷13x50	24x25÷24x50	14x15÷14x50	35x36÷35x44	<p>NR 7</p> <p>C</p>
8x9÷8x56	15x16÷15x50															
9x10÷9x50	16x17÷16x50															
10x11÷10x50	17x18÷17x50															
11x12÷11x50	18x19÷18x50															
12x13÷12x50	19x20÷20x50															
13x14÷13x50	24x25÷24x50															
14x15÷14x50	35x36÷35x44															

	<p>Rundstempel ř (mm)</p> <p>40,0 ÷ 90,0 Größe von 0,5 mm</p>	<p>NR 11</p> <p>C</p>														
	<p>Langlochstempel (mm)</p> <p>10,0x90,0 ÷ 80,0x90,0 Größe von 0,5 mm</p>	<p>NR 11</p> <p>C</p>														
	<p>Vierkantstempel (mm)</p> <p>20,0 ÷ 64,0 Größe von 1 mm</p>	<p>NR 11</p> <p>C</p>														
	<p>Rechteck (mm)</p> <table border="1"> <tbody> <tr> <td>8x9÷8x86</td> <td>15x16÷15x82</td> </tr> <tr> <td>9x10÷9x82</td> <td>16x17÷16x82</td> </tr> <tr> <td>10x11÷10x82</td> <td>17x18÷17x82</td> </tr> <tr> <td>11x12÷11x82</td> <td>18x19÷18x82</td> </tr> <tr> <td>12x13÷12x82</td> <td>19x20÷20x82</td> </tr> <tr> <td>13x14÷13x82</td> <td>24x25÷24x82</td> </tr> <tr> <td>14x15÷14x82</td> <td>35x36÷35x82</td> </tr> </tbody> </table>	8x9÷8x86	15x16÷15x82	9x10÷9x82	16x17÷16x82	10x11÷10x82	17x18÷17x82	11x12÷11x82	18x19÷18x82	12x13÷12x82	19x20÷20x82	13x14÷13x82	24x25÷24x82	14x15÷14x82	35x36÷35x82	<p>NR 11</p> <p>C</p>
8x9÷8x86	15x16÷15x82															
9x10÷9x82	16x17÷16x82															
10x11÷10x82	17x18÷17x82															
11x12÷11x82	18x19÷18x82															
12x13÷12x82	19x20÷20x82															
13x14÷13x82	24x25÷24x82															
14x15÷14x82	35x36÷35x82															

	<p>Abrunden (mm)</p> <table border="1"> <tr><td>R 5</td><td>R 10</td><td>R 15</td></tr> <tr><td>R 6</td><td>R 11</td><td></td></tr> <tr><td>R 7</td><td>R 12</td><td></td></tr> <tr><td>R 8</td><td>R 13</td><td></td></tr> <tr><td>R 9</td><td>R 14</td><td></td></tr> </table>	R 5	R 10	R 15	R 6	R 11		R 7	R 12		R 8	R 13		R 9	R 14		<p>NR 3</p> <p>C</p>
R 5	R 10	R 15															
R 6	R 11																
R 7	R 12																
R 8	R 13																
R 9	R 14																
	<p>Abrunden (mm)</p> <table border="1"> <tr><td>R 5</td><td>R 10</td><td>R 15</td></tr> <tr><td>R 6</td><td>R 11</td><td></td></tr> <tr><td>R 7</td><td>R 12</td><td></td></tr> <tr><td>R 8</td><td>R 13</td><td></td></tr> <tr><td>R 9</td><td>R 14</td><td></td></tr> </table>	R 5	R 10	R 15	R 6	R 11		R 7	R 12		R 8	R 13		R 9	R 14		<p>NR 4</p> <p>A</p>
R 5	R 10	R 15															
R 6	R 11																
R 7	R 12																
R 8	R 13																
R 9	R 14																
	<p>Abrunden (mm)</p> <table border="1"> <tr><td>R 5</td><td>R 10</td><td>R 15</td></tr> <tr><td>R 6</td><td>R 11</td><td></td></tr> <tr><td>R 7</td><td>R 12</td><td></td></tr> <tr><td>R 8</td><td>R 13</td><td></td></tr> <tr><td>R 9</td><td>R 14</td><td></td></tr> </table>	R 5	R 10	R 15	R 6	R 11		R 7	R 12		R 8	R 13		R 9	R 14		<p>NR 5</p> <p>B</p>
R 5	R 10	R 15															
R 6	R 11																
R 7	R 12																
R 8	R 13																
R 9	R 14																
	<p>Abrunden (mm)</p> <table border="1"> <tr><td>R 5</td><td>R 10</td><td>R 15</td></tr> <tr><td>R 6</td><td>R 11</td><td></td></tr> <tr><td>R 7</td><td>R 12</td><td></td></tr> <tr><td>R 8</td><td>R 13</td><td></td></tr> <tr><td>R 9</td><td>R 14</td><td></td></tr> </table>	R 5	R 10	R 15	R 6	R 11		R 7	R 12		R 8	R 13		R 9	R 14		<p>NR 6</p> <p>C</p>
R 5	R 10	R 15															
R 6	R 11																
R 7	R 12																
R 8	R 13																
R 9	R 14																
	<p>Abrunden (mm)</p> <table border="1"> <tr><td colspan="3">R10 ÷ R35</td></tr> <tr><td colspan="3">Größe von 1 mm</td></tr> </table>	R10 ÷ R35			Größe von 1 mm			<p>NR 7</p> <p>C</p>									
R10 ÷ R35																	
Größe von 1 mm																	

	<p>Abrunden (mm)</p> <p>R 5 R 10</p> <p>R 6</p> <p>R 7</p> <p>R 8</p> <p>R 9</p>	<p>NR 3</p> <p>C</p>
	<p>Abrunden (mm)</p> <p>R 5 R 10 R 15</p> <p>R 6 R 11</p> <p>R 7 R 12</p> <p>R 8 R 13</p> <p>R 9 R 14</p>	<p>NR 4</p> <p>A</p>
	<p>Abrunden (mm)</p> <p>R 5 R 10 R 15</p> <p>R 6 R 11</p> <p>R 7 R 12</p> <p>R 8 R 13</p> <p>R 9 R 14</p>	<p>NR 5</p> <p>B</p>
	<p>Abrunden (mm)</p> <p>R 5 R 10 R 16</p> <p>R 6 R 11 R 17</p> <p>R 7 R 12 R 18</p> <p>R 8 R 13 R 19</p> <p>R 9 R 14 R 20</p> <p>R 10 R 15</p>	<p>NR 6</p> <p>C</p>
	<p>Abrunden (mm)</p> <p>R 5 R 10 R 16 R 22</p> <p>R 6 R 11 R 17 R 23</p> <p>R 7 R 12 R 18 R 24</p> <p>R 8 R 13 R 19 R 25</p> <p>R 9 R 14 R 20 R 26</p> <p>R 10 R 15 R 21 R 27</p>	<p>NR 7</p> <p>C</p>

	<p>Rundmatrize \checkmark (mm)</p> <p>3,2 ÷ 31,2 Größe von 0,5 mm</p>	<p>NR 2</p> <p>A</p>
	<p>Langlochstempel (mm)</p> <p>5,2x10,2 ÷ 22,7x30,7 Größe von 0,5 mm</p>	<p>NR 2</p> <p>A</p>
	<p>Vierkantmatrize (mm)</p> <p>4,2 ÷ 20,7 Größe von 0,5 mm</p>	<p>NR 2</p> <p>A</p>
	<p>Rechteck (mm)</p> <p>8,2x9,2 ÷ 20,2x24,2 8,7x9,7 ÷ 20,7x24,7 Größe von 0,5 mm</p>	<p>NR 2</p> <p>A</p>
	<p>Exzentermatrize \checkmark (mm)</p> <p>5,2 ÷ 18,7 Größe von 0,5 mm</p>	<p>NR 13</p> <p>A</p>

	<p>Rundmatrize \checkmark (mm)</p> <p>3,2 ÷ 33,2 Größe von 0,5 mm</p>	<p>NR 3</p> <p>B</p>
	<p>Langlochstempel (mm)</p> <p>5,2x10,2 ÷ 22,7x31,7 Größe von 0,5 mm</p>	<p>NR 3</p> <p>B</p>
	<p>Vierkantmatrize (mm)</p> <p>4,2 ÷ 22,7 Größe von 0,5 mm</p>	<p>NR 3</p> <p>B</p>
	<p>Rechteck (mm)</p> <p>8,2x9,2 ÷ 20,2x30,2 8,7x9,7 ÷ 20,7x30,7 Größe von 0,5 mm</p>	<p>NR 3</p> <p>B</p>
	<p>Exzentermatrize \checkmark (mm)</p> <p>5,7 ÷ 24,7 Größe von 0,5 mm</p>	<p>NR 14</p> <p>B</p>

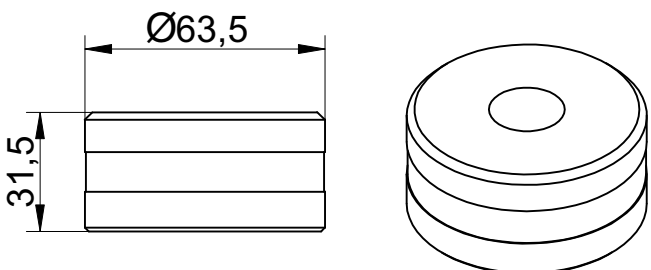
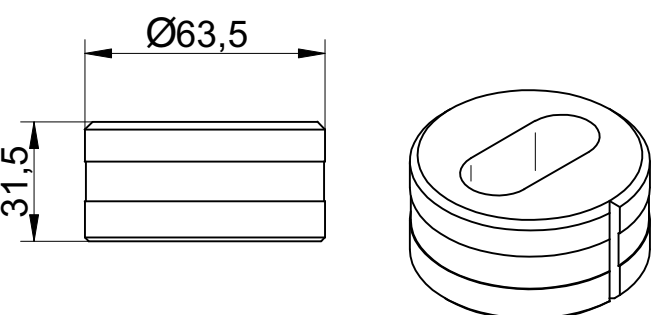
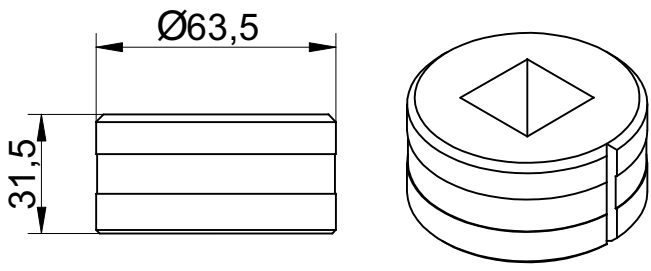
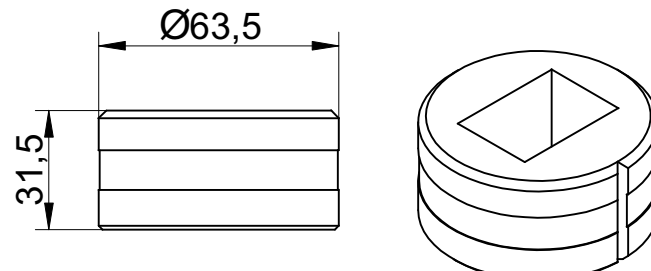
	<p>Rundmatrize ř (mm)</p> <p>3,2 ÷ 40,7 Größe von 0,5 mm</p>	<p>NR 4</p> <p>C</p>
	<p>Langlochstempel (mm)</p> <p>5,2x10,2 ÷ 22,7x31,7 Größe von 0,5 mm</p>	<p>NR 4</p> <p>C</p>
	<p>Vierkantmatrize (mm)</p> <p>4,2 ÷ 28,7 Größe von 0,5 mm</p>	<p>NR 4</p> <p>C</p>
	<p>Rechteck (mm)</p> <p>8,2x9,2 ÷ 20,2x45,2 8,7x9,7 ÷ 20,7x45,7 Größe von 0,5 mm</p>	<p>NR 4</p> <p>C</p>

	<p>Rundmatrize r (mm)</p> <p>40,2 ÷ 65,7 Größe von 0,5 mm</p>	<p>NR 6</p> <p>C</p>
	<p>Langlochstempel (mm)</p> <p>5,2x10,2 ÷ 22,7x55,7 Größe von 0,5 mm</p>	<p>NR 6</p> <p>C</p>
	<p>Vierkantmatrize (mm)</p> <p>4,2 ÷ 40,7 Größe von 0,5 mm</p>	<p>NR 6</p> <p>C</p>
	<p>Rechteck (mm)</p> <p>8,2x9,2 ÷ 20,2x65,2 8,7x9,7 ÷ 20,7x65,7 Größe von 0,5 mm</p>	<p>NR 6</p> <p>C</p>

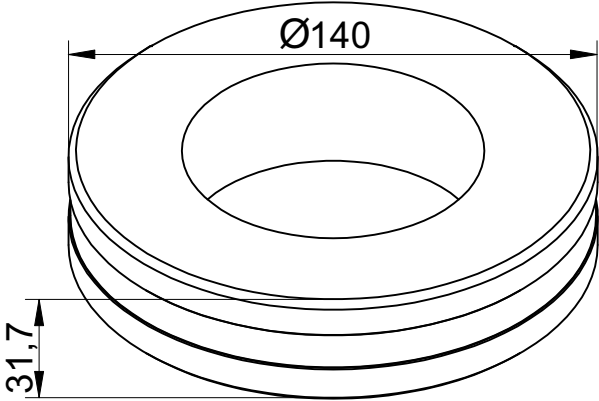
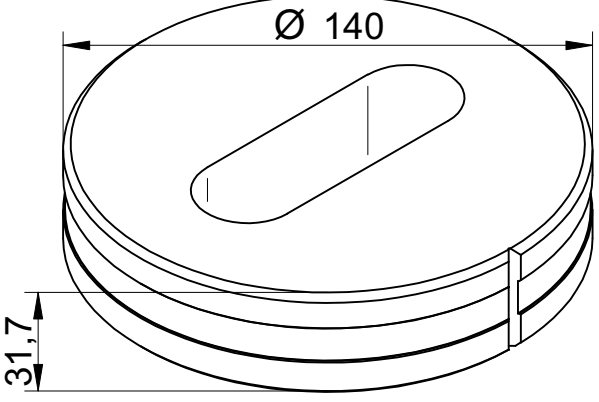
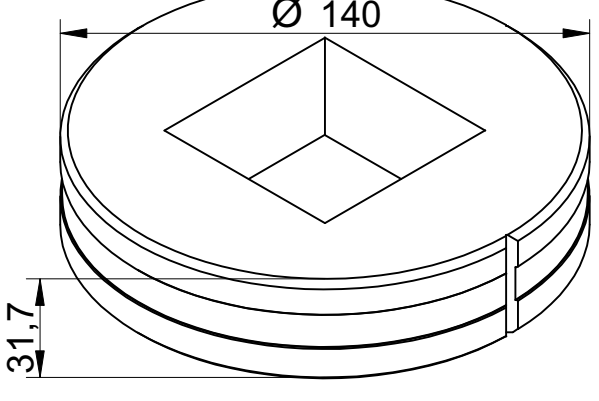
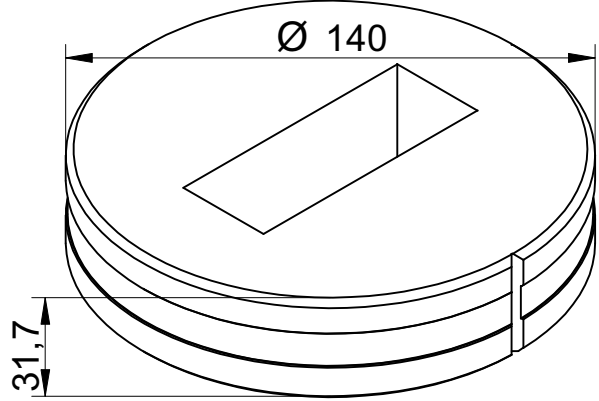
	<p>Rundmatrize \checkmark (mm)</p> <p>40,2 ÷ 100,7 Größe von 0,5 mm</p>	<p>NR 20</p> <p>C</p>
	<p>Langlochmatrize (mm)</p> <p>5,2x10,2 ÷ 80,7x90,7 Größe von 0,5 mm</p>	<p>NR 20</p> <p>C</p>
	<p>Vierkantmatrize (mm)</p> <p>4,2 ÷ 64,7 Größe von 0,5 mm</p>	<p>NR 20</p> <p>C</p>
	<p>Rechteck (mm)</p> <p>8,2x9,2 ÷ 35,2x82,2 8,7x9,7 ÷ 35,7x82,7 Größe von 0,5 mm</p>	<p>NR 20</p> <p>C</p>

	<p>Abrunden (mm)</p> <table border="1"> <tr><td>R 5</td><td>R 10</td><td>R 15</td></tr> <tr><td>R 6</td><td>R 11</td><td></td></tr> <tr><td>R 7</td><td>R 12</td><td></td></tr> <tr><td>R 8</td><td>R 13</td><td></td></tr> <tr><td>R 9</td><td>R 14</td><td></td></tr> </table>	R 5	R 10	R 15	R 6	R 11		R 7	R 12		R 8	R 13		R 9	R 14		<p>NR 2</p>						
R 5	R 10	R 15																					
R 6	R 11																						
R 7	R 12																						
R 8	R 13																						
R 9	R 14																						
	<p>Abrunden (mm)</p> <table border="1"> <tr><td>R 5</td><td>R 10</td><td>R 15</td></tr> <tr><td>R 6</td><td>R 11</td><td></td></tr> <tr><td>R 7</td><td>R 12</td><td></td></tr> <tr><td>R 8</td><td>R 13</td><td></td></tr> <tr><td>R 9</td><td>R 14</td><td></td></tr> </table>	R 5	R 10	R 15	R 6	R 11		R 7	R 12		R 8	R 13		R 9	R 14		<p>NR 3</p>						
R 5	R 10	R 15																					
R 6	R 11																						
R 7	R 12																						
R 8	R 13																						
R 9	R 14																						
	<p>Abrunden (mm)</p> <table border="1"> <tr><td>R 5</td><td>R 10</td><td>R 15</td></tr> <tr><td>R 6</td><td>R 11</td><td>R 20</td></tr> <tr><td>R 7</td><td>R 12</td><td></td></tr> <tr><td>R 8</td><td>R 13</td><td></td></tr> <tr><td>R 9</td><td>R 14</td><td></td></tr> </table>	R 5	R 10	R 15	R 6	R 11	R 20	R 7	R 12		R 8	R 13		R 9	R 14		<p>NR 4</p>						
R 5	R 10	R 15																					
R 6	R 11	R 20																					
R 7	R 12																						
R 8	R 13																						
R 9	R 14																						
	<p>Abrunden (mm)</p> <table border="1"> <tr><td>R 10</td><td>R 17</td><td>R 24</td></tr> <tr><td>R 11</td><td>R 18</td><td>R 25</td></tr> <tr><td>R 12</td><td>R 19</td><td>R 26</td></tr> <tr><td>R 13</td><td>R 20</td><td>R 27</td></tr> <tr><td>R 14</td><td>R 21</td><td>R 28</td></tr> <tr><td>R 15</td><td>R 22</td><td>R 29</td></tr> <tr><td>R 16</td><td>R 23</td><td>R 30</td></tr> </table>	R 10	R 17	R 24	R 11	R 18	R 25	R 12	R 19	R 26	R 13	R 20	R 27	R 14	R 21	R 28	R 15	R 22	R 29	R 16	R 23	R 30	<p>NR 6</p>
R 10	R 17	R 24																					
R 11	R 18	R 25																					
R 12	R 19	R 26																					
R 13	R 20	R 27																					
R 14	R 21	R 28																					
R 15	R 22	R 29																					
R 16	R 23	R 30																					
	<p>Abrunden (mm)</p> <p>R10 ÷ R35 Größe von 1 mm</p> <p>Sonderfertigung</p>	<p>NR 20</p>																					

<p>Ø 46,04</p>	<p>Abrunden (mm)</p> <p>R 5 R 10</p> <p>R 6</p> <p>R 7</p> <p>R 8</p> <p>R 9</p>	<p>NR 2</p> <p>A</p>
<p>Ø 50,8</p>	<p>Abrunden (mm)</p> <p>R 5 R 10 R 15</p> <p>R 6 R 11</p> <p>R 7 R 12</p> <p>R 8 R 13</p> <p>R 9 R 14</p>	<p>NR 3</p> <p>B</p>
<p>Ø 63,5</p>	<p>Abrunden (mm)</p> <p>R 5 R 10 R 15</p> <p>R 6 R 11</p> <p>R 7 R 12</p> <p>R 8 R 13</p> <p>R 9 R 14</p>	<p>NR 4</p> <p>C</p>
<p>Ø 90</p>	<p>Abrunden (mm)</p> <p>R 5 R 10 R 16</p> <p>R 6 R 11 R 17</p> <p>R 7 R 12 R 18</p> <p>R 8 R 13 R 19</p> <p>R 9 R 14 R 20</p> <p>R 10 R 15</p>	<p>NR 6</p> <p>C</p>
<p>Ø 140</p>	<p>Abrunden (mm)</p> <p>R 5 R 10 R 16 R 22</p> <p>R 6 R 11 R 17 R 23</p> <p>R 7 R 12 R 18 R 24</p> <p>R 8 R 13 R 19 R 25</p> <p>R 9 R 14 R 20 R 26</p> <p>R 10 R 15 R 21 R 27</p> <p>Sonderfertigung</p>	<p>NR 20</p> <p>C</p>

Sonderwerkzeuge

Sonderstempel und Sondermatrizen
(d.h. Sondergröße und Eigenschneidspalt)
Die Fertigung nach Muster oder Zeichnung

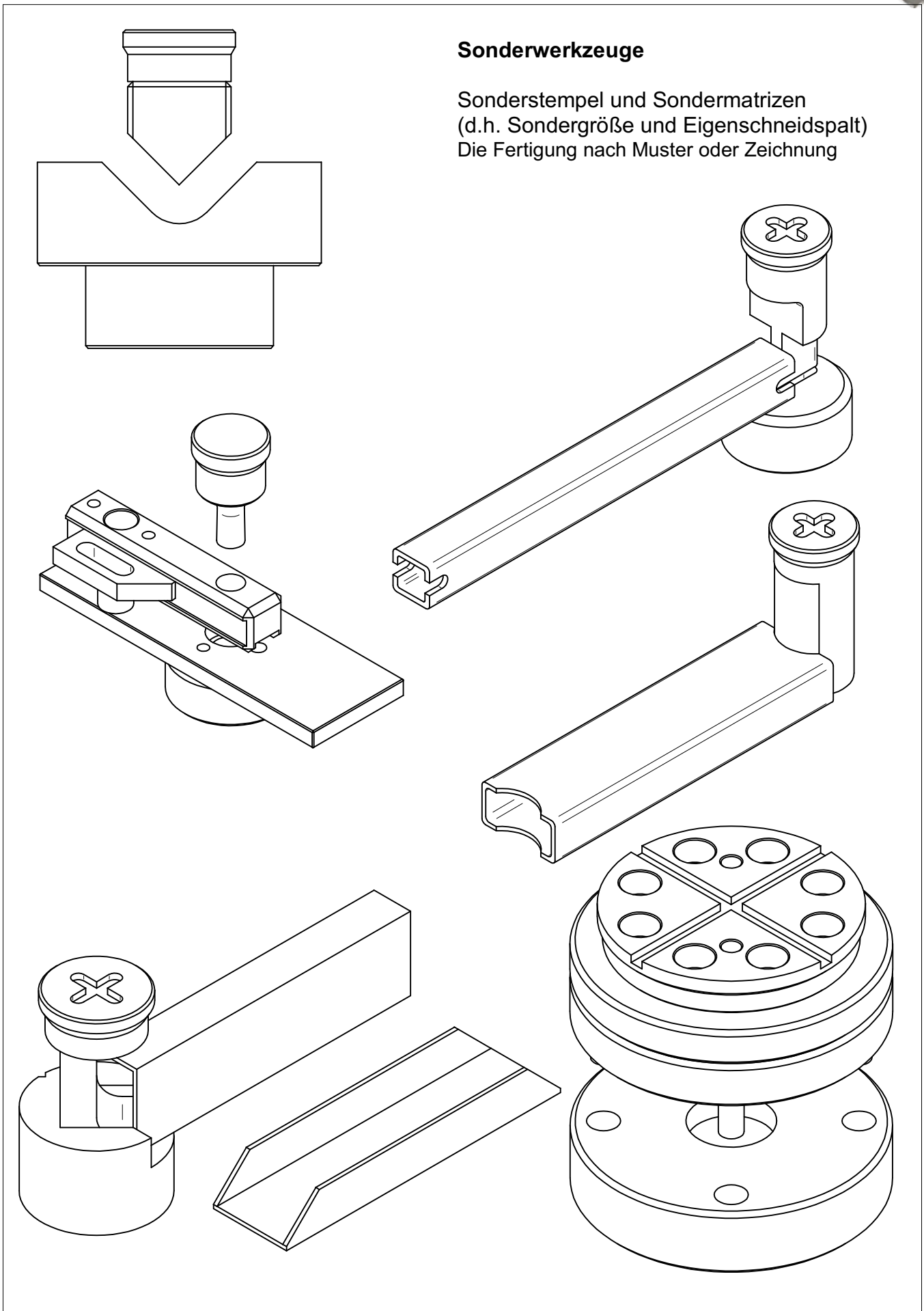

Sonderwerkzeuge

Sonderstempel und Sondermatrizen
(d.h. Sondergröße und Eigenschneidspalt)
Die Fertigung nach Muster oder Zeichnung

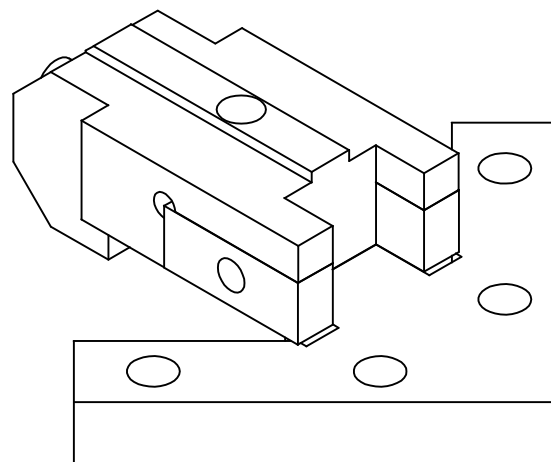
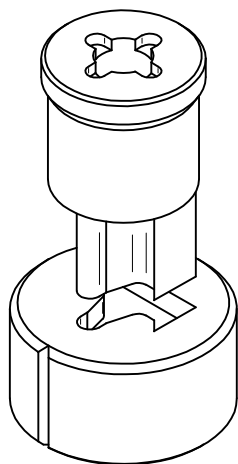
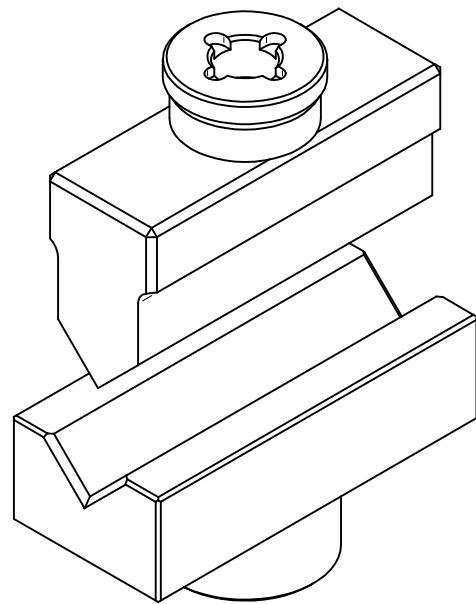
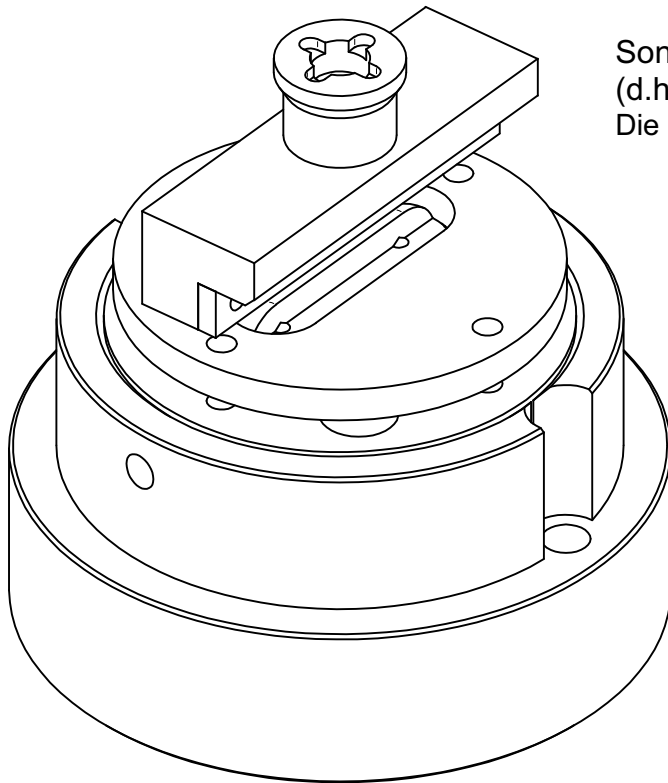

Sonderwerkzeuge

Sonderstempel und Sondermatrizen
(d.h. Sondergröße und Eigenschneidspalt)
Die Fertigung nach Muster oder Zeichnung

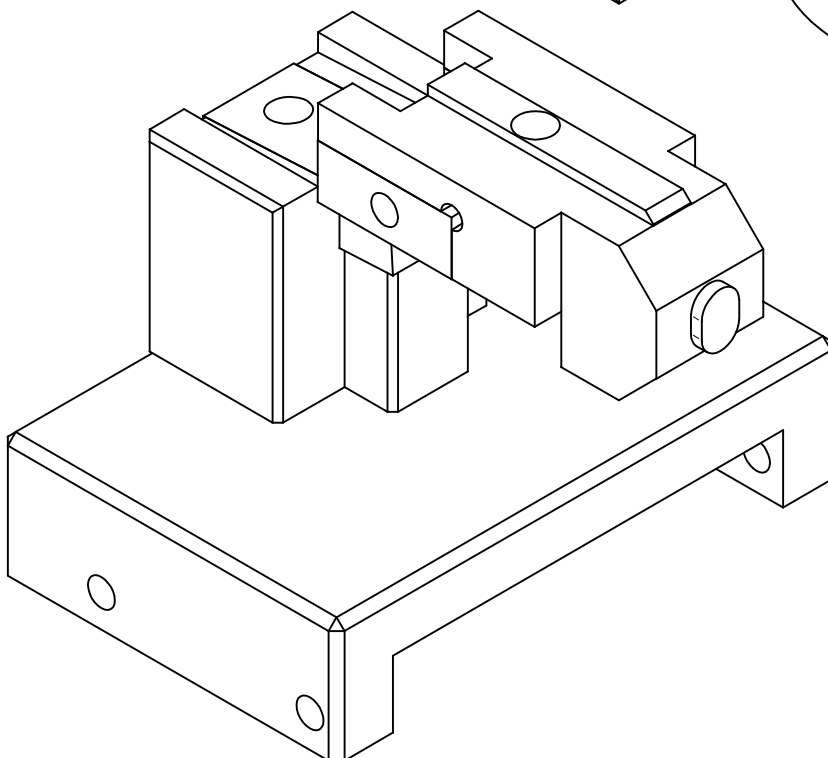
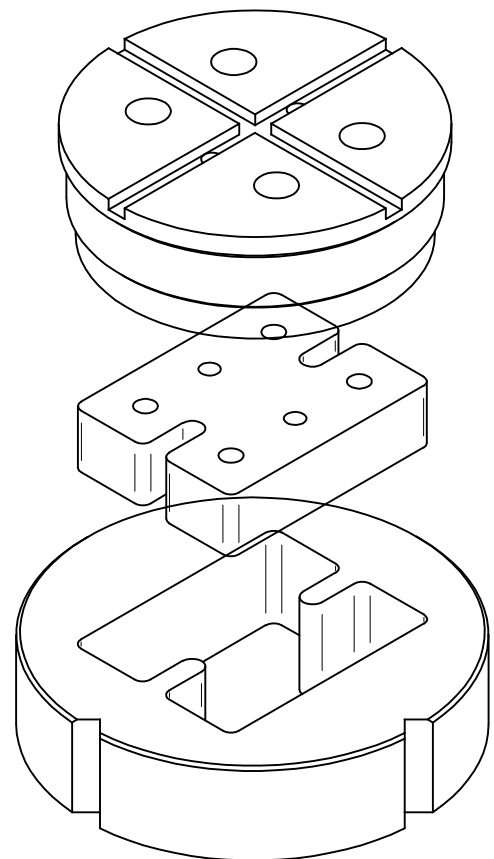
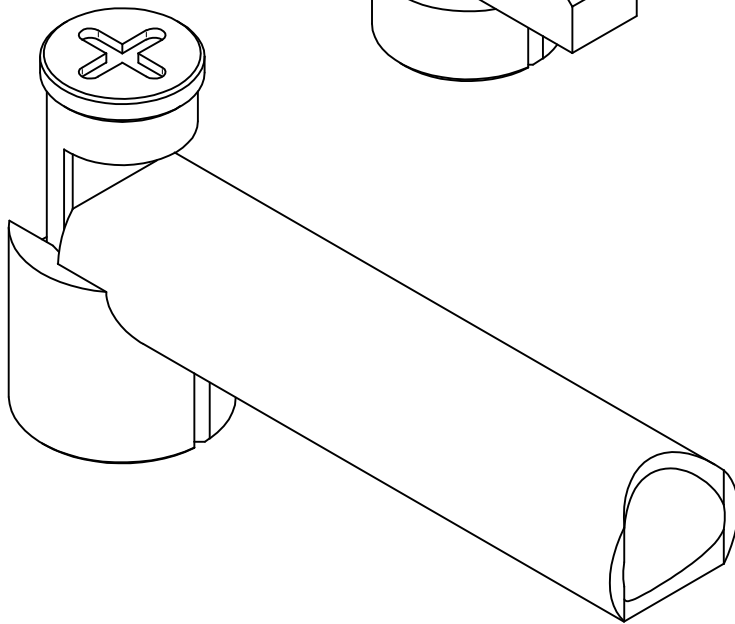
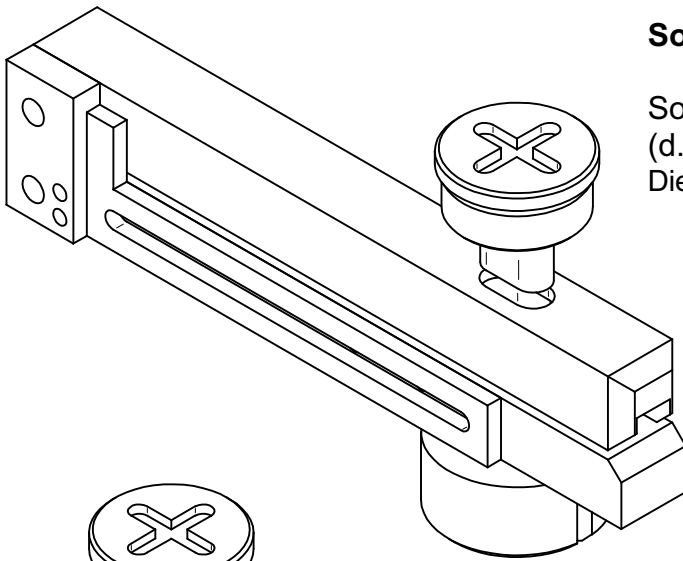



PROJEKTENWICKLUNG UND HERSTELLUNG VON:

- **SCHNEID UND STANZWERKZEUGEN • MATRIZEN UND DURSCHLAGSTEMPELN**
 - **MATRIZEN UND SCHNEIDSTEMPELN**
- (**NC BEARBEITUNG • TECHNISCHE GRAVUR • HÄRTEPROZESSE**)
- **PROTOTYPEN UND SERIENFERTIGUNG**



WROMET Sp. z o.o.
ul. Kaczeńcowa 2
62-510 Konin

tel. +48 63 245 80 01
info@wromet.com.pl

NIP PL 665-294-89-81
KRS: 000362355